



SECURILOCK - RECOMMENDED TOOLS FOR INSTALLATION

- Soft cleaning cloths / tissue
- Cone-Cut bit for metal (smooth type) (see Drg.A).
- Pencil (soft lead).
- Waxoyl / WD40 (Anti-corrosion treatment), (see Drg.B).
- Adjustable set square (small & large type), (Drg.C)
- Door panel removal tools (Various).
- Cordless drill
- De-burring tool, (Drg.D).
- Mallet (rubber/plastic).
- Torch (small inspection / flexi type).
- Allen Keys set (for lock bolts & striker screws)
- Socket set (Metric – ¼" or ½" Drive).
- Brush (suitable for removing swarf).
- Rivet crimping tool (See Below)
- Lighting

CAUTION

It is advised that appropriate safety wear is worn, throughout the installation of Securilock.



EAR DEFENDERS

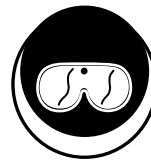

SAFETY GLASSES



SAFETY GLOVES

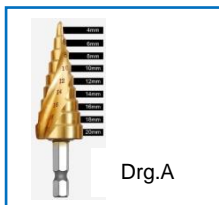

Drg.A

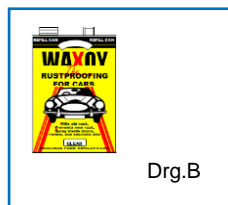

Drg.B

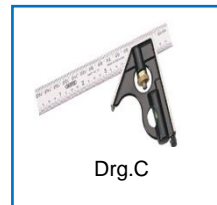

Drg.C



Drg.D

Rivet Tools:



Note:

Please note that the rivets used by Securilock **MUST** be installed with the appropriate tools. They are installed with tools that pull the rivet and do not turn them and do not rotate it.

FITTING INSTRUCTIONS



GMC SAVANA

BACK DOOR



ENSURE THAT THE VEHICLE E.O. DOOR LATCH IS FUNCTIONING CORRECTLY. READ THE SUPPLIED INSTALLATION INSTRUCTIONS FULLY BEFORE STARTING ANY FITTING OF THIS LOCK

- 1-Remove any ply-lining (if fitted), from both lower rear door sections.
- 2- Remove both lower rear panels using a suitable trim clip tool.
- 3- Clean area where lock will be fitted.
- 4- Stick adhesive drilling template to door in line with measurements market below.



Photo 1

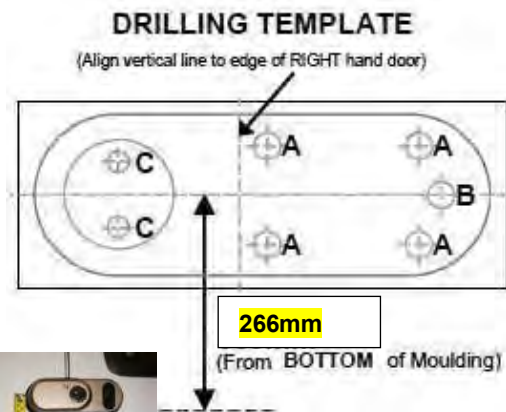

Drilling Fixing Holes

- Centre punch, drill pilot holes (A, B & C)
- Remove template.

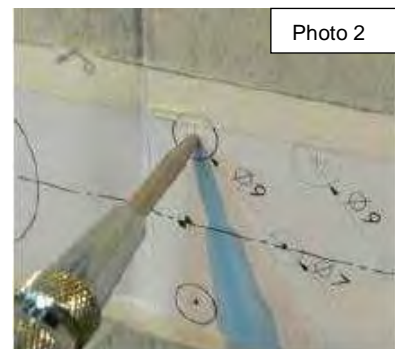

Photo 2

FITTING INSTRUCTIONS



BACK DOOR

Photo 3

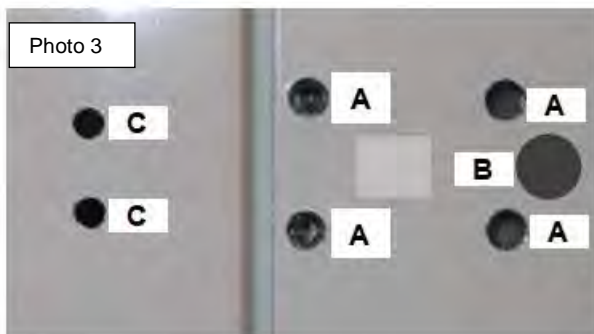

- Drill 4 x holes **(A)** to a maximum size of **9mm**.
 - Drill 1 x hole **(B)** to a maximum size of **10mm**.
 - Drill 2 x holes **(C)** to a maximum size of **9mm**.
- Note:** it will also be necessary to drill through the edge of an inner brace, when drilling holes **(C)**.

(Note: All holes should be de-burred, where possible).

- Apply the anti-corrosion substance supplied, or paint holes.

Photo 4

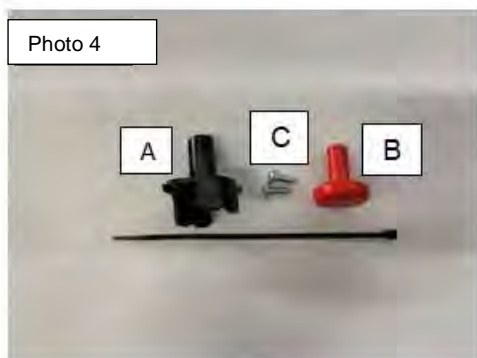

Escape Cable Handle Components

Remove the following:-

- A.** Cable Collar Support Bracket.
- B.** Escape Knob.
- C.** Small fitting screws.

Photo 5

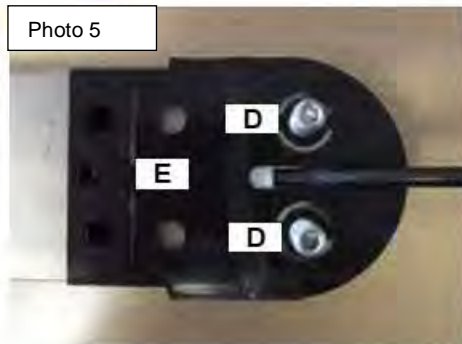

Assemble Unit prior to fitting to door

Fit 2 x **M8 Studs** with plusnuts **(D)** (fit with socket heads facing inwards). (Use of a thread locking compound is recommended). Fit Plastic Lock Shroud **(E)** over Escape Cable and Studs

Photo 6



Fitting Gatelock Van to door

- Insert Escape Cable through hole **(B)**, followed by **M8 studs**.
- Hold unit, fit **M8 Cap Bolts** with Lip Plate through door edge **(G)**. (DO NOT TIGHTEN FULLY).

FITTING INSTRUCTIONS



BACK DOOR

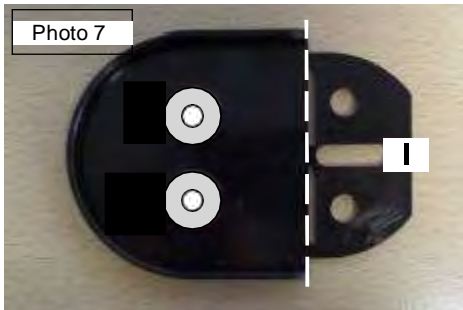

- Remove Plastic 'Unit Tilt' section (I).

Use cut off section (I) if Unit requires tilting over to improve locking, (this is more typical for barn doors).



- Cut the edges where they will be installed the plusnuts.

Fitting Locking Strike

- Apply an anticorrosion substance or paint holes
- Fit M6 screws through strike plate with plusnuts
- Fit screws through plastic shroud.
- Fit screws through drilled holes

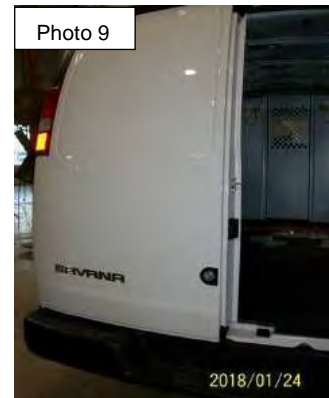

Internal Escape Cable Fitting

Step 1: Drill a 13mm hole on the door sheet metal (Or panel)

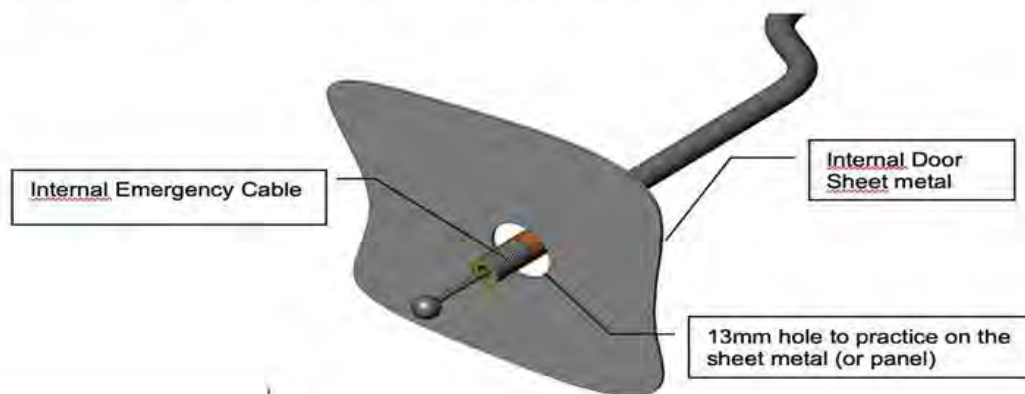

FITTING INSTRUCTIONS



BACK DOOR

Step 2: Insert the red knob in its support, paying attention to align the holes as indicated below



Step 3: Insert the terminal of the cable in its seat.



Step 4: Screw the plastic support until the ball end of the cable aligns with the top hole of the support



Step 5: Insert the support into the door sheet metal and close the padlock by rotating the harpoon (the red knob will return). Carry out some functional tests before fixing the plastic support. If necessary, screw or unscrew the support to adjust the stroke.

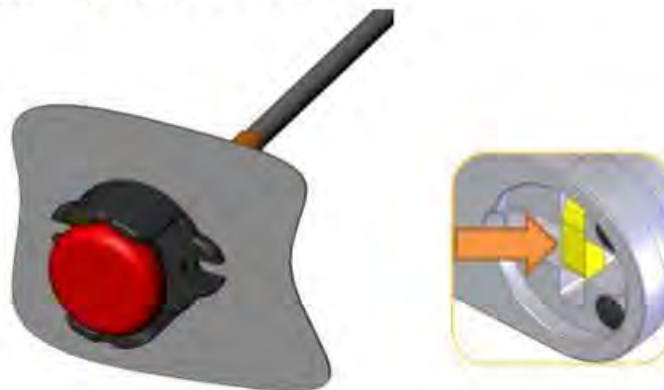

FITTING INSTRUCTIONS



BACK DOOR



Step 6: Fix the support to the door sheet onto the panel using the screws provided. Check that the passing hole of the knob and that of the support are aligned in order to guarantee the passage of the safety seal.



Step 7: Fix the support to the door sheet or to the panel using the screws provided.

NOTE: The emergency cable allows the use of a security seal. The use is **NOT MANDATORY** and it prevents the functioning of the emergency cable in case of any need.

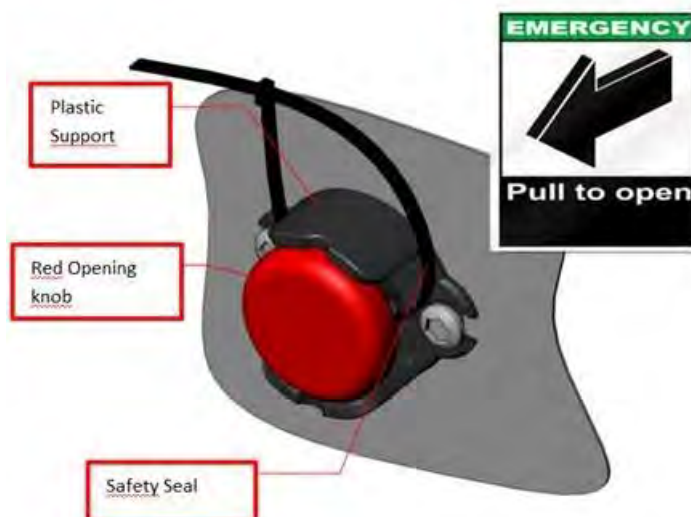

FITTING INSTRUCTIONS



BACK DOOR

Hold Emergency Escape Cable

- Choose a position on the inside face of the door That has adequate access to fit the cable through The door (ensure cable will not be kinded or Interfere with latch etc)
- Centre punch, drill 8mm hole
- Push plastic support through drilled hole, fit screws to secure.

Photo 10



Photo 11



Fitted Lock Unit



Completion

- Ensure UNIT is level and tighten all fixings.

Testing (With door Open)

- Close strike lever on Unit, insert key to release
 - CAREFULLY close door onto Strike plate, to ensure lever will engage, if adjustment of the Strike plate is required, slightly loosen Screws and adjust as necessary.
 - Close strike lever on Unit, test Handle to release.
 - Close door, Use key to release lock, and open door by vehicle handle.
 - Re-fit door panels etc
- Cut an access in ply-lining for the emergency escape if necessary

FITTING INSTRUCTIONS



GMC SAVANA

SWING-OUT-SIDE DOOR



ENSURE THAT THE VEHICLE E.O. DOOR LATCH IS FUNCTIONING CORRECTLY. READ THE SUPPLIED INSTALLATION INSTRUCTIONS FULLY BEFORE STARTING ANY FITTING OF THIS LOCK

LEGEND Fleet Solutions accepts no responsibility for damage or mistake

- 1-Remove any ply-lining (if fitted), from both lower side doors
- 2-Remove both lower panels using a suitable trim clip tool.
- 3-Clean area where lock will be fitted.
- 4-Stick adhesive drilling template to door in line with measurements market below.

Lock fitting



Photo 1



Photo 2

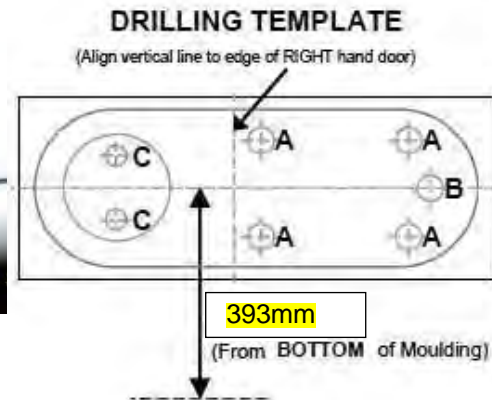

FITTING INSTRUCTIONS



SIDE DOOR

Photo 3

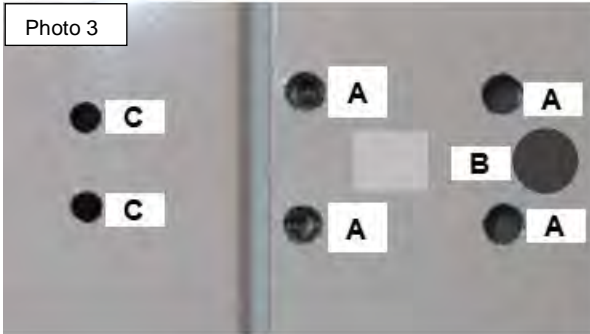

- Drill 4 x holes **(A)** to a maximum size of **9mm**.
- Drill 1 x hole **(B)** to a maximum size of **10mm**.
- Drill 2 x holes **(C)** to a maximum size of **9mm**.
Note: it will also be necessary to drill through the edge of an inner brace, when drilling holes (C).

(Note: All holes should be de-burred, where possible).

- Apply the anti-corrosion substance supplied, or paint holes.

Photo 4

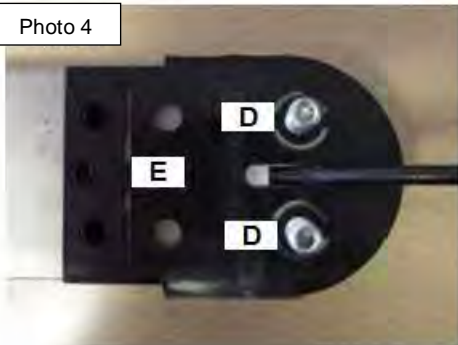

Assemble Unit prior to fitting to door

- Fit 2 x M8 Studs, **(D)** (fit with socket heads facing inwards). (Use of a thread locking compound is recommended).
- Fit Plastic Lock Shroud **(E)** over Escape Cable and Studs.

Photo 5

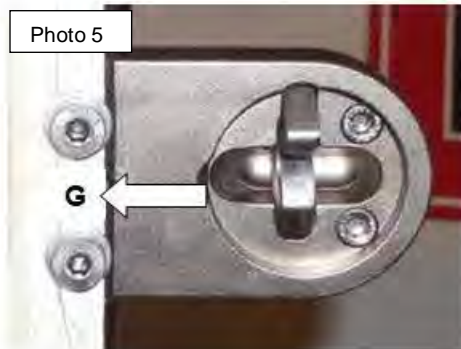

Fitting Gatelock to door

- Fit 2 x M8 Studs with plusnuts **(D)** (fit with socket heads facing inwards). (Use of a thread locking compound is recommended). Fit Plastic Lock Shroud **(E)** over Escape Cable and Studs

FITTING INSTRUCTIONS



SIDE DOOR

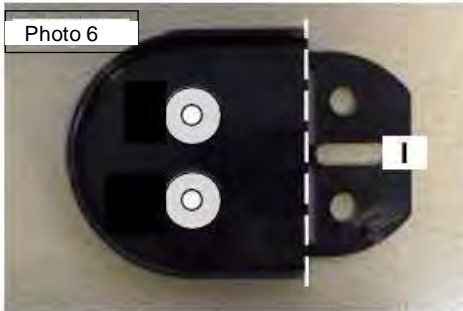

Photo 6

- Remove Plastic 'Unit Tilt' section (I).

Use cut off section (I) if Unit requires tilting over to improve locking, (this is more typical for barn doors).

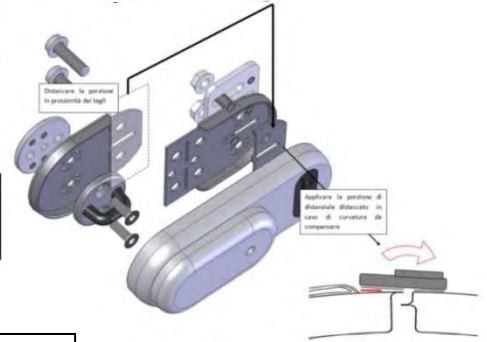

Photo 7

- Cut The edges where they will be installed the plusnuts (Photo 7)

Fitting Locking Strike

- Apply an anticorrosion substance or paint holes
- Fit M6 screws through strike plate with plusnuts
- Fit screws through plastic schroud, followed by external plate
- Fit screws through drilled holes

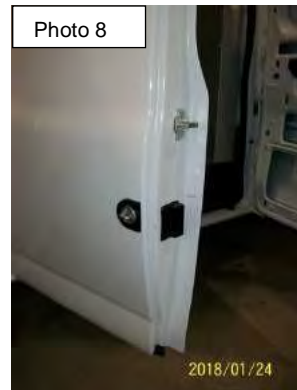
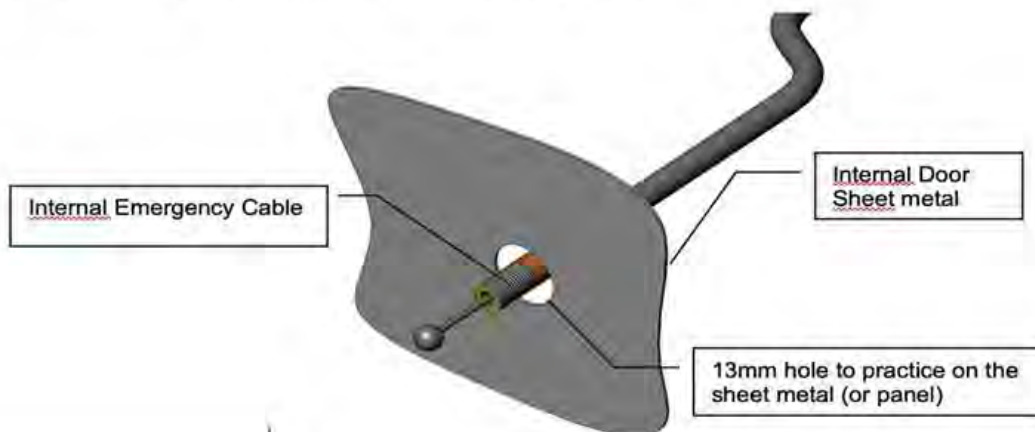

Photo 8

Internal Escape Cable Fitting

Step 1: Drill a 13mm hole on the door sheet metal (Or panel)



FITTING INSTRUCTIONS



SIDE DOOR

Step 2: Insert the red knob in its support, paying attention to align the holes as indicated below



Step 3: Insert the terminal of the cable in its seat.



Step 4: Screw the plastic support until the ball end of the cable aligns with the top hole of the support



Step 5: Insert the support into the door sheet metal and close the padlock by rotating the harpoon (the red knob will return). Carry out some functional tests before fixing the plastic support. If necessary, screw or unscrew the support to adjust the stroke.

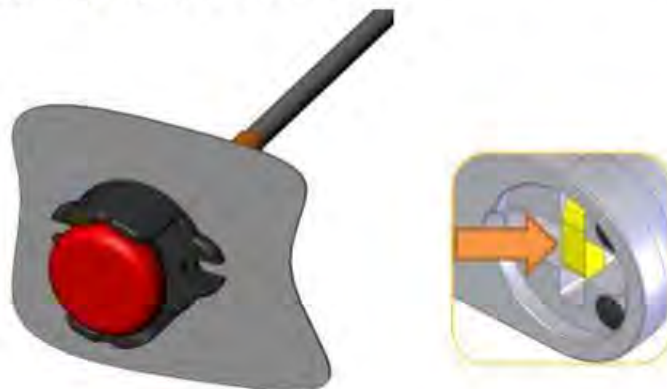

FITTING INSTRUCTIONS



SIDE DOOR



Step 6: Fix the support to the door sheet or to the panel using the screws provided. Check that the passing hole of the knob and that of the support are aligned in order to guarantee the passage of the safety seal



Step 7: Fix the support to the door sheet or to the panel using the screws provided.

NOTE: The emergency cable allows the use of a security seal. The use is **NOT MANDATORY** and it prevents the functioning of the emergency cable in case of any need.

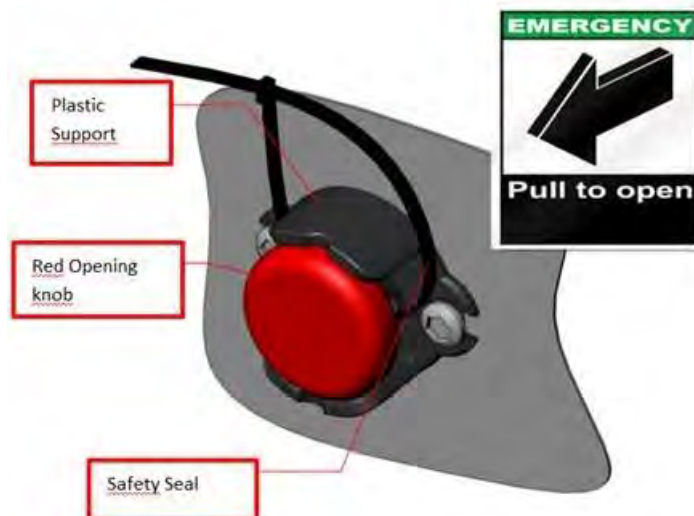

FITTING INSTRUCTIONS



SIDE DOOR

Hold Emergency Escape Cable

- Choose a position on the inside face of the door That has adequate access to fit the cable through The door (ensure cable will not be kinded or Interfere with latch etc)
- Centre punch, drill 8mm hole
- Push plastic support through drilled hole, fit screws to secure

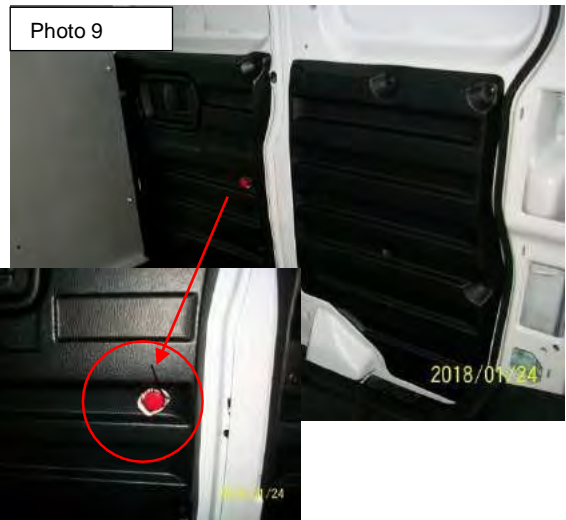

Fitted lock Unit



Completion

- Ensure UNIT is level and tighten all fixings.

Testing (With door Open)

- Close strike lever on Unit, insert key to release
- CAREFULLY close door onto Strike plate, to ensure lever will engage, if adjustment of the Strike plate is required, slightly loosen Screws and adjust as necessary.
- Close strike lever on Unit, test Handle to release.
- Close door, Use key to release lock, and open door by vehicle handle.
- Re-fit door panels etc
- Cut an access in ply-lining for the emergency escape if necessary.